

* STAGE FOUR *

RULES: Practical Shooting Handbook, Latest Edition **COURSE DESIGNER:** GWELBORN

START POSITION: Standing with loaded handgun holstered as per 8.1.1 and 8.1.2. PCC start position is standing with stock on belt, muzzle downrange, loaded carbine held in both hands with safety on. Bat Door closed on start.

STAGE PROCEDURE

On signal engage targets as visible respecting fault lines.

All walls, doors, barrels, snow fence walls are hardcover from the ground up unless otherwise specified.

SCORING

SCORING : Comstock, 30 rounds, 150 points

TARGETS: 13 IPSC 4 STEEL

SCORED HITS: Best 2 per IPSC,
steel down = 1A

START-STOP: Audible - Last shot

PENALTIES: Procedural. -10

No-shoot hit. -10

Miss. -10

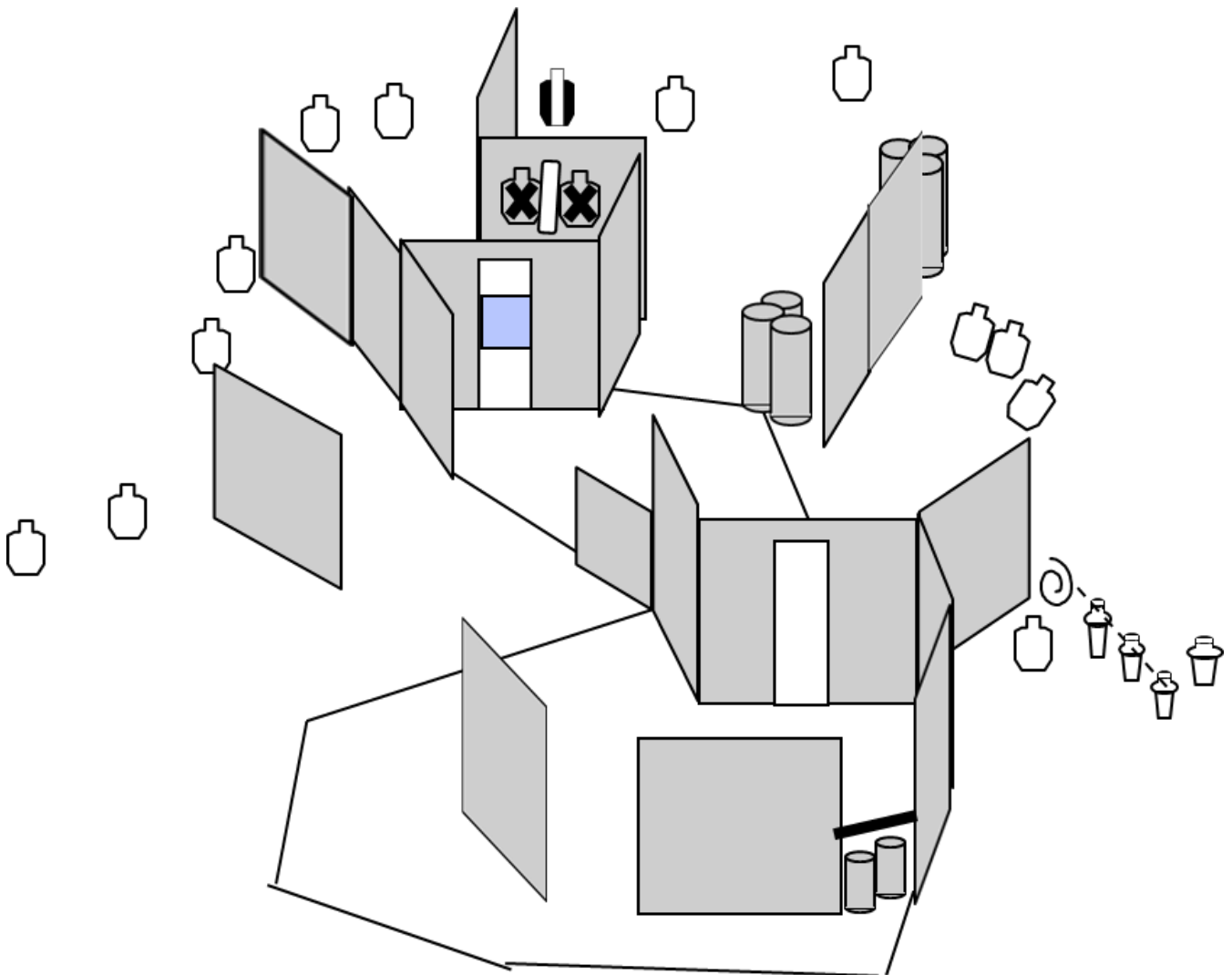

BAY 4

RO NOTES: