

* STAGE TWO

RULES: Practical Shooting Handbook, Latest Edition **COURSE DESIGNER:** GWELBORN

START POSITION: DOOR CLOSED ON START. Standing **hands relaxed at sides** with loaded handgun holstered as per 8.1.1 and 8.1.2. PCC start position is standing with stock on belt, muzzle downrange, loaded carbine held in both hands with safety on. DOOR CLOSED ON START,

STAGE PROCEDURE	SCORING
<p>On signal engage targets as visible respecting fault lines.</p> <p>All walls, doors, barrels, snow fence walls are hardcover from the ground up unless otherwise specified.</p>	<p>SCORING : Comstock, 31 rounds, 155 points</p> <p>TARGETS: 11 IPSC 9 STEEL</p> <p>SCORED HITS: Best 2 per IPSC, steel down = 1A</p> <p>START-STOP: Audible - Last shot</p> <p>PENALTIES: Procedural. -10 No-shoot hit. -10 Miss. -10</p>

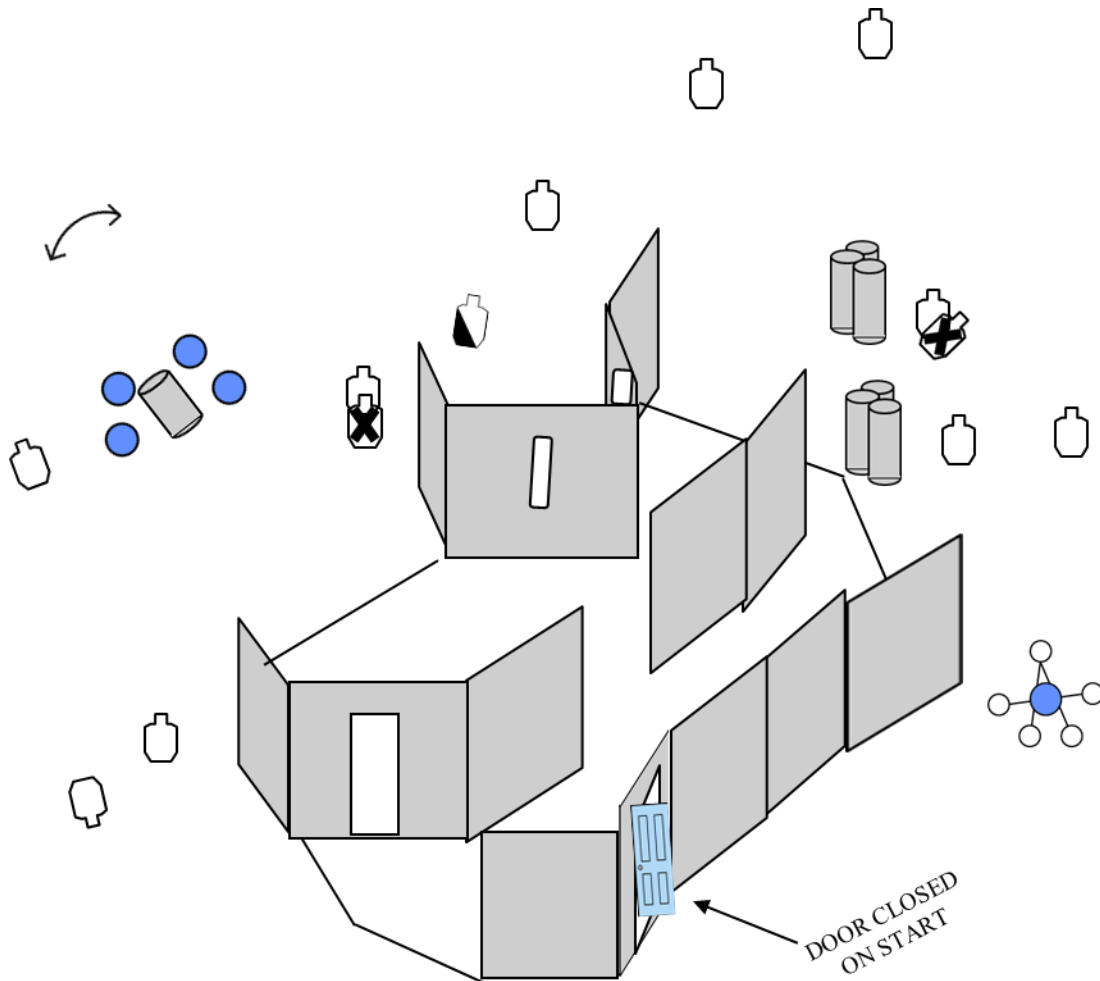

BAY 2 RO NOTES: