

# \* ALL ABOARD(s/p)\*

**RULES:**

**DESIGNER:** GWELBORN

**START POSITION:** Standing with toes on X, shotgun at low ready and handgun in pistol box.

## STAGE PROCEDURE

On signal engage steel with shot only, ground shotgun in box, and engage paper tgts with pistol only. Engage all targets as visible respecting fault lines.

All walls, barrels, snow fence walls are hardcover from the ground up unless otherwise specified.

## SCORING

**SCORING :** 10 shot, 16 pistol, -  
- 125 points maximum

**TARGETS:** Pistol= IPSC Paper -  
- shot= steel

**SCORED HITS:** Best 2 per paper,  
steel down

**START-STOP:** Audible - Last shot

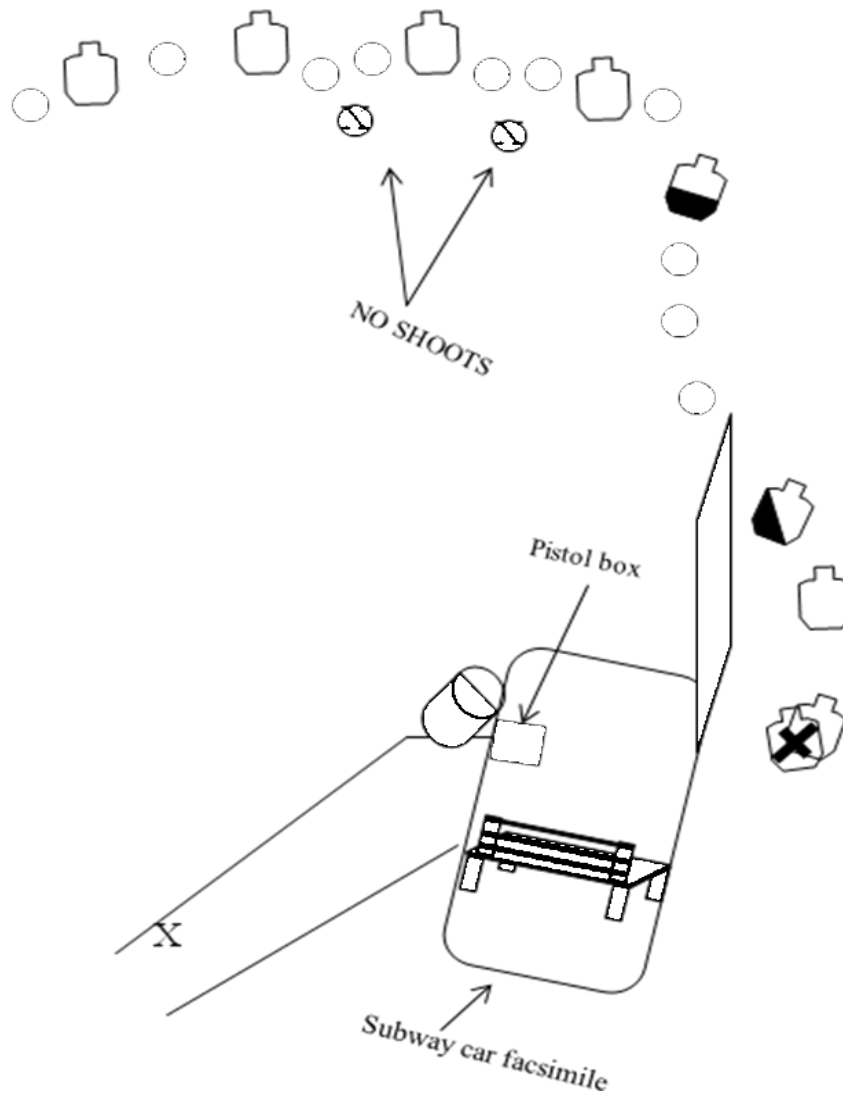

STAGE 6

RO NOTES: